

# RACK-A-TIERS®

## SPECIALTY ELECTRICAL TOOLS



### SPECIFICATIONS

Product Name	Penguin Puller Jr	Penguin Puller Sr
Brand	RACK-A-TIERS	RACK-A-TIERS
Part Number	69705	69700
Product UPC	625912697058	625912697003
Product Weight	1.13 lbs	1.79lbs
Product Dimensions (L x W x H)	3.50 x 1.63 x 1.63	4" x 2" x 2"
Packaged Product Weight (L x W x H)	1.8lbs	2lbs
Packaged product Dimensions	7" x 5" x 2"	7" x 5" x 2"
Product Material	Stainless Steel	Stainless Steel
Product Type	Wire Fishing & Pulling / Wire Fishing & Pulling Accessories	Wire Fishing & Pulling / Wire Fishing & Pulling Accessories
Max Pull Strength	4,000lbs	4,000lbs
Wire size	2/0 to 4/0 Copper or Aluminum (2" Pipe or Larger).	3/0 to 350 MCM Copper or Aluminum (2-1/2" Pipe or Larger).
Color	Metal	Metal
Country of Origin	US	US

### Product Features

The Penguin Puller Sr. and Jr. are revolutionary new tools designed to aid in easily pulling in large cables. Pulling in underground feeds has never been easier. Attach your cables to the Penguin Puller, attach your rope and get pulling. The sleek, bullet shape allows for seamless pulling, no tape or crimps required. Utilizing four slots and Allen-key set screws the Penguin Puller Sr. and Jr. are rated for 4,000 lbs. of pull strength.

- 4 Wire Slots.
- Attachment hole for Sr. & Jr. is .63 of an inch in diameter.
- No tape, no crimps, no mess.
- Reusable.

### Flush Pin Shackle

Part Number: 69710

Product Material: Stainless Steel

Load Size: Four Ton Break Load

Pin Size: 0.5in

Product Dimensions: 6.75" x 4" x 1" 0.4 lbs

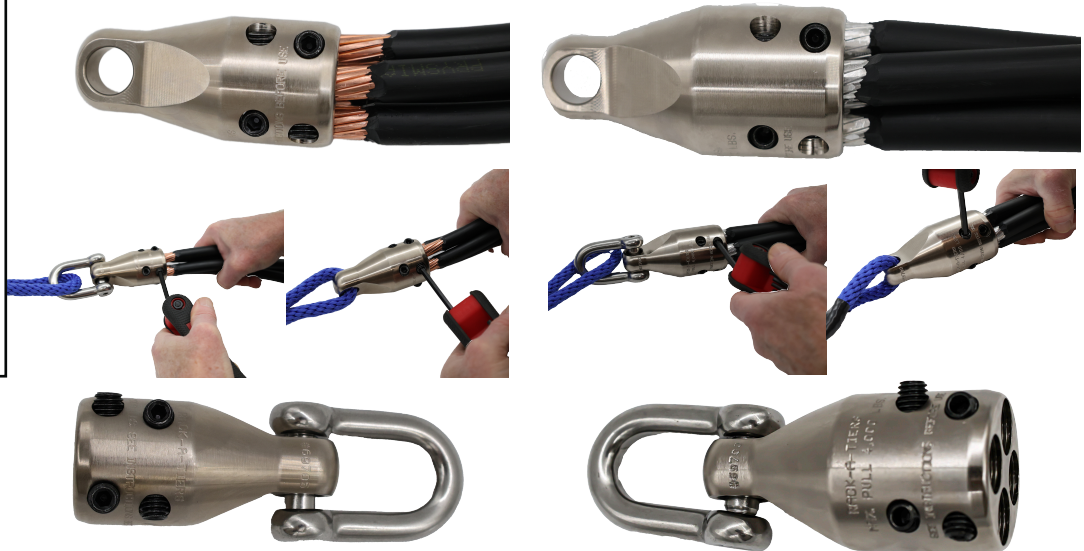

FOLLOW US ON



WWW.RACK-A-TIERS.COM

SALES@RACK-A-TIERS.COM

TOLL FREE: 1 (888) 939-9991



# SPECIALTY ELECTRICAL TOOLS

## Penguin Puller Jr. (Part# 69705) & Penguin Puller Sr. (Part# 69700) Instruction Manual

The Penguin Puller Jr. and Sr. are built to pull feed wires in a quick and efficient manner.

### Specifications:

#### Penguin Puller Jr. 69705

Max. Wire Size: 4/0 Copper or Aluminum  
Min. Wire Size: 2/0 Copper or Aluminum

Max. Pull Strength: 4,000 lbs.\* (May vary with wire size, weather conditions and tightness of set screws.)

Conduit Size 2" and Larger

#### Penguin Puller Sr. 69700

Max. Wire Size: 350 MCM Copper or Aluminum  
Min. Wire Size: 3/0 Copper or Aluminum

Max. Pull Strength: 4,000 lbs.\* (May vary with wire size, weather conditions and tightness of set screws.)

Conduit Size 2 1/2" and Larger



### Instructions:

To use the Penguin Puller Jr. or Sr. first strip 4" of the wire coating off the ends of the wire you wish to pull. Insert your wires into the provided end holes and tighten the 2 Allen-Key set screws per hole firmly (limit 1 wire per hole). Attach rope, clevis or other pulling device to the hole provided on the head of the Penguin Puller.

Do NOT use on live circuits. The user should be sure that all circuits have been de-energized before using the Penguin Puller Jr. or Sr.

Always use eye protection when working with the Penguin Puller Jr.



\*RACK-A-TIERS assumes NO liability and will NOT be held responsible for damage, loss, injury or death. By purchasing the Penguin Puller Jr. or Sr. the user/purchaser assumes all responsibility and will NOT hold RACK-A-TIERS liable.



FOLLOW US ON



WWW.RACK-A-TIERS.COM

SALES@RACK-A-TIERS.COM

TOLL FREE: 1 (888) 939-9991